

Rated voltage	200-220	V AC
Rated power	400	W
Rated torque	1.27	N.m
Peak torque	3.81	N.m
Rated speed	3000	RPM
Max speed	6000	RPM
Rated current	3.0	A _{rms}
peak current	9	A _{rms}
Torque Const	0.524	N.m/A _{rms}
Back EMF Const	31.7	V/KRPM
Resistance	2.7 ±10%	Ω
Inductance	6 ±20%	mH
Inertia	0.42	kg·m ² ·10 ⁻⁴
poles	10	
Encoder line	2500 lines	
Winding line	18AWG	
Brake line	22AWG	
protection level	IP54	

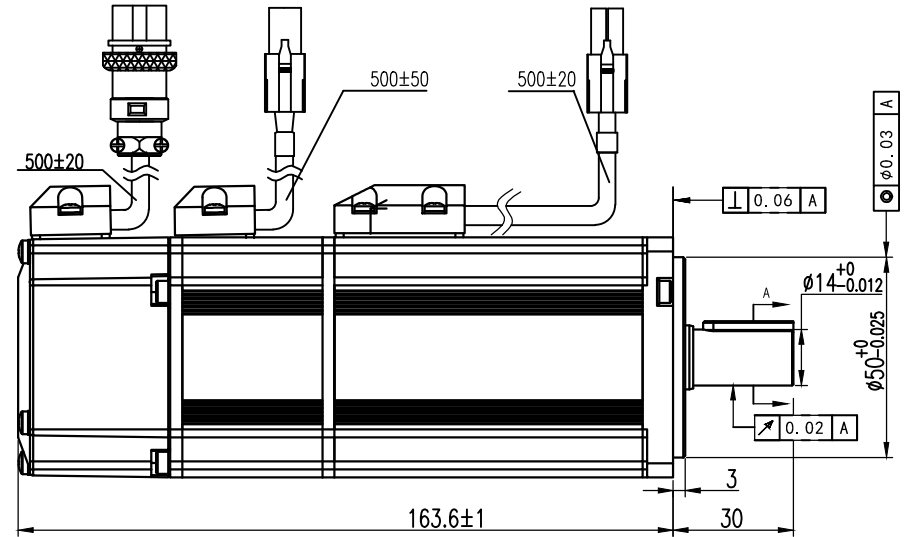

Motor side connector

connector	winding connector	encoder connector	braker connector
Terminal	AMP770903-1	19M-15K	AMP770903-1
Plastic shell	AMP172167-1		AMP172165-1

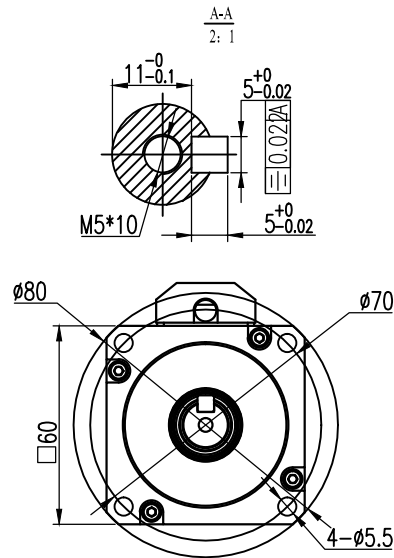
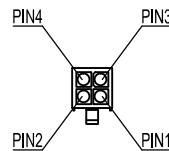

winding connector				
pin	1	2	3	4
colour	blue	red	black	yel/gre
signal	U	W	V	PE

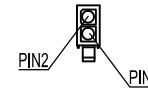

brake connector		
pin	1	2
signal	0V	24V

Driver side connector

connector	winding connector	encoder connector	braker connector
Terminal	AMP770904-1	19M-15A	AMP770904-1
Plastic shell	AMP172159-1		AMP172157-1



wiring order of encoder connector															
pin	1	2	3	4	5	6	7	8	9	10	11	12	13	14	15
signal	shield	red	black	green	Yel/whi	blue	yellow	Blue/whi	grey	brang	brown	Ora/whi	Gre/whi	Gre/whi	Ora/whi
colour	PE	5V	0V	B+	Z-	U+	Z+	U-	A+	W+	V+	W-	A-	B-	V-

Leadshine Technology Co. Ltd

60mm / 400w/ low inertia
motor with brake

ELM0400BL-60G-HS